

751

30.35

30.35

30.35

90°

15

90°

741

740

30.30

450m²

739

30

30

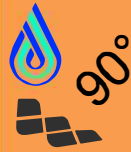

15

90°



PALUMA

GROVE

30.00

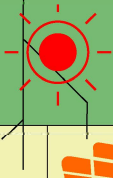

LEGEND:

Drainage Services



Sewer Line

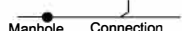

Electrical



Water Services



Brick Paving



Social Housing



Footpath



Retaining Wall



Vehicle Access Restriction



Garage Location



Padmount site



Lot Levels



Road Level



Bushfire Attack Level



NORTH



Scale 1:250

All Dimensions and Areas are subject to survey. The particulars on this brochure are supplied for identification purposes only and shall not be taken as a representation in any aspect on the part of the vendor or its agents. Authorities should be consulted when services are contained within lot boundaries as building restrictions may apply. All retaining walls, services and associated easements are shown exaggerated for legibility.



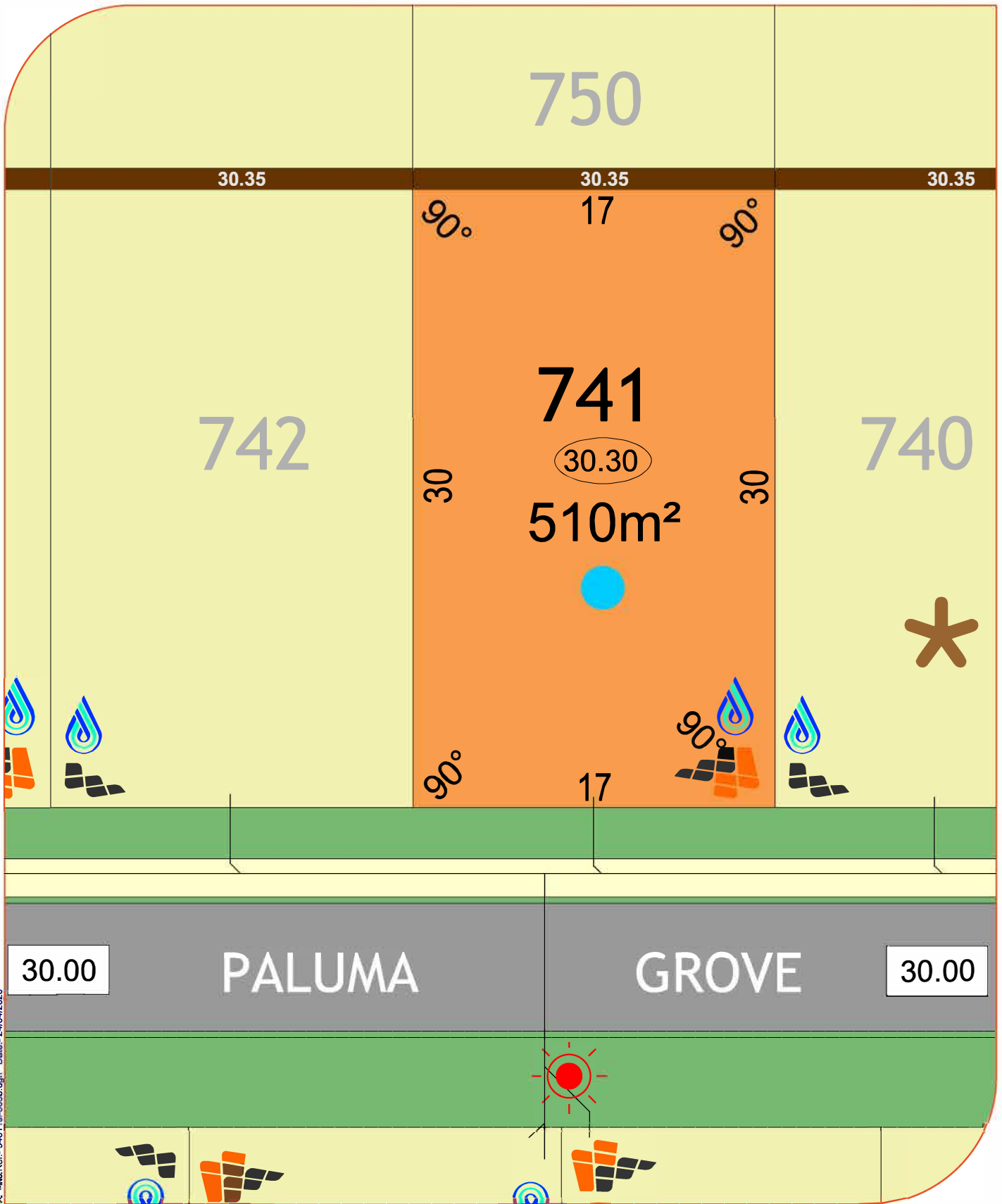

MNG.Ref. 94611s-309b.dgn Date: 24/04/2020

LEGEND:

- | | | | | | | | |
|-------------------|------------|----------------|-----------|----------------------------|-----------------------|----------------|--|
| Drainage Services | Manhole | Side Entry Pit | Grate | Brick Paving | Padmount site | Lot Levels | NORTH

Scale 1:250 |
| Sewer Line | Manhole | Connection | | Social Housing | Lot Levels | 34.67
39.50 | |
| Electrical | Powerdome | Connection | Lightpole | Footpath | Bushfire Attack Level | | |
| Water Services | Connection | Valve | Hydrant | Retaining Wall | BAL 12.5 | BAL 29 | |
| | | | Deferred | Vehicle Access Restriction | BAL 19 | BAL 40 | |
| | | | | Garage Location | | | |

All Dimensions and Areas are subject to survey. The particulars on this brochure are supplied for identification purposes only and shall not be taken as a representation in any aspect on the part of the vendor or its agents. Authorities should be consulted when services are contained within lot boundaries as building restrictions may apply. All retaining walls, services and associated easements are shown exaggerated for legibility.



749

30.35

30.35

30.35

90°

17

90°

30.35

743

742

30.30

510m²

741

30

30

17

90°

PALUMA

30.00

GROVE

MNG.Ref. 94611s-305b.dgn Date: 24/04/2020

LEGEND:

Drainage Services



Sewer Line

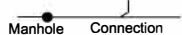

Electrical



Water Services



Brick Paving



Social Housing



Footpath



Retaining Wall



Vehicle Access Restriction



Garage Location



Padmount site



Lot Levels



Road Level



Bushfire Attack Level



NORTH



Scale 1:250

All Dimensions and Areas are subject to survey. The particulars on this brochure are supplied for identification purposes only and shall not be taken as a representation in any aspect on the part of the vendor or its agents. Authorities should be consulted when services are contained within lot boundaries as building restrictions may apply. All retaining walls, services and associated easements are shown exaggerated for legibility.



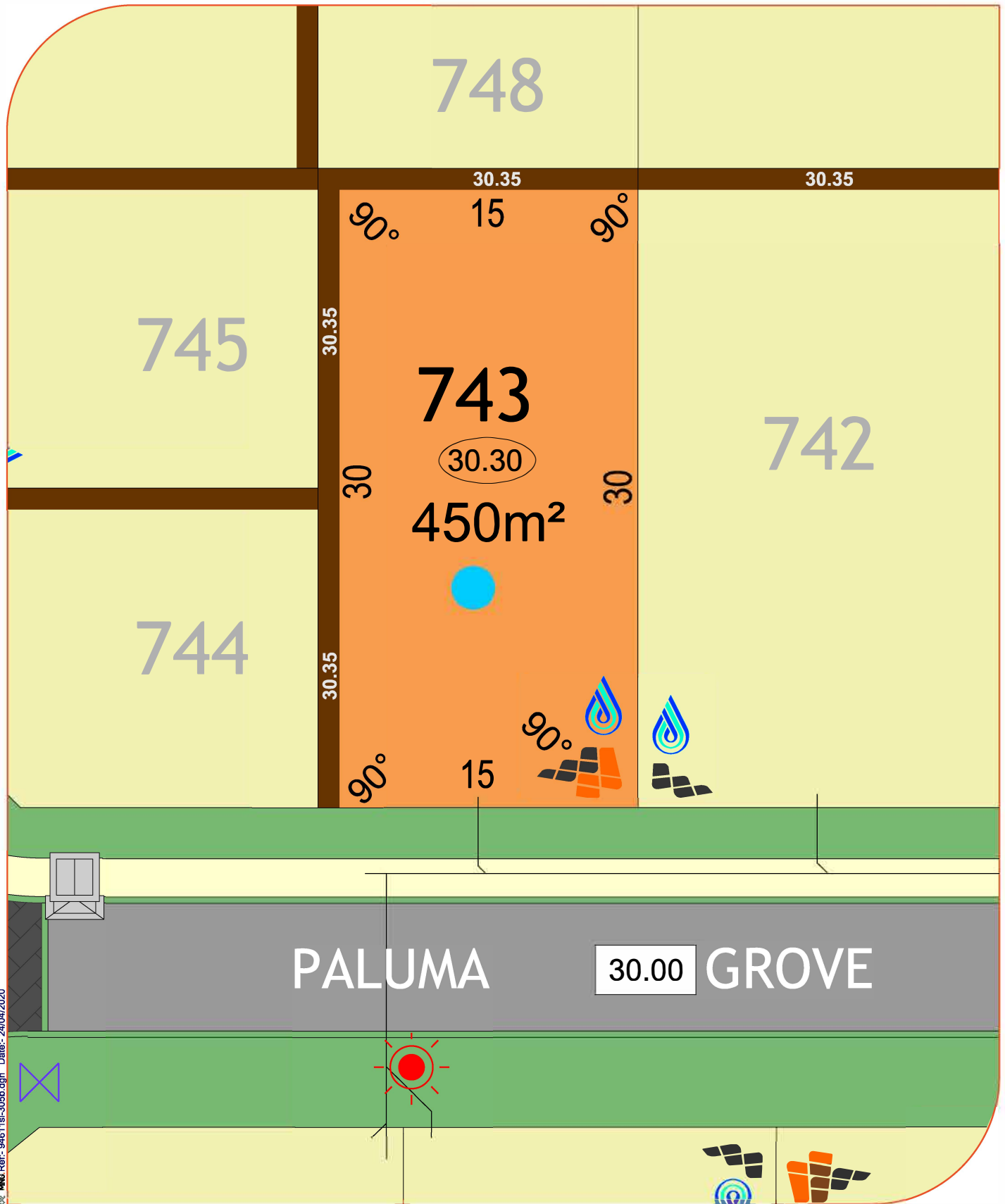

MNG Ref- 94611si-305b.dgn Date- 24/04/2020

LEGEND:

- | | | | | | | | |
|-------------------|------------|----------------|-----------|----------------|----------------------------|-----------------------|--|
| Drainage Services | Manhole | Side Entry Pit | Grate | Brick Paving | Padmount site | Lot Levels | NORTH

Scale 1:250 |
| Sewer Line | Manhole | Connection | | Social Housing | Lot Levels | 34.67
39.50 | |
| Electrical | Powerdome | Connection | Lightpole | Footpath | Retaining Wall | Bushfire Attack Level | |
| Water Services | Connection | Valve | Hydrant | Deferred | Vehicle Access Restriction | BAL 12.5 | |
| | | | | | Garage Location | BAL 19 | |
| | | | | | | BAL 29 | |
| | | | | | | BAL 40 | |

All Dimensions and Areas are subject to survey. The particulars on this brochure are supplied for identification purposes only and shall not be taken as a representation in any aspect on the part of the vendor or its agents. Authorities should be consulted when services are contained within lot boundaries as building restrictions may apply. All retaining walls, services and associated easements are shown exaggerated for legibility.



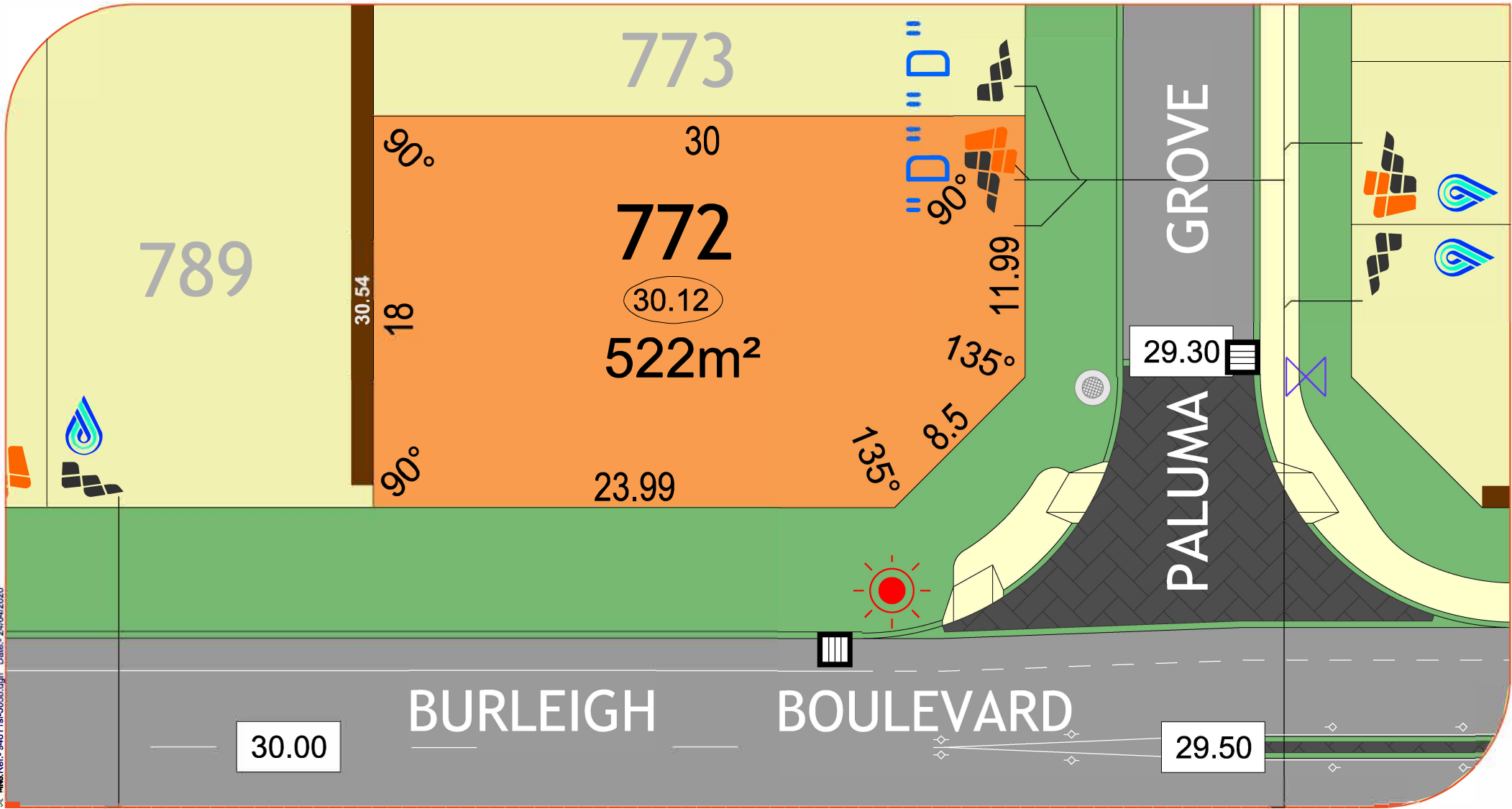

MWA Ref: 94611sl-305b.dgn Date: 24/04/2020

LEGEND:

- | | | | | | | | | | | | | | | | |
|--------------------------|------------|----------------|---------|-----------------------|-----------|------------|-----------|-----------------------------------|--|----------------------|-------|------------------------------|----------|--------|--------------|
| Drainage Services | Manhole | Side Entry Pit | Grate | Electrical | Powerdome | Connection | Lightpole | Footpath | | Lot Levels | 34.67 | Bushfire Attack Level | BAL 12.5 | BAL 29 | NORTH |
| Sewer Line | Manhole | Connection | | Brick Paving | | | | Retaining Wall | | Road Level | 39.50 | BAL 19 | BAL 40 | | |
| Water Services | Connection | Valve | Hydrant | Social Housing | | | | Vehicle Access Restriction | | Padmount site | | Garage Location | | | |
| | 'D' | | | | | | | | | | | | | | |

All Dimensions and Areas are subject to survey. The particulars on this brochure are supplied for identification purposes only and shall not be taken as a representation in any aspect on the part of the vendor or its agents. Authorities should be consulted when services are contained within lot boundaries as building restrictions may apply. All retaining walls, services and associated easements are shown exaggerated for legibility.

Scale 1:250

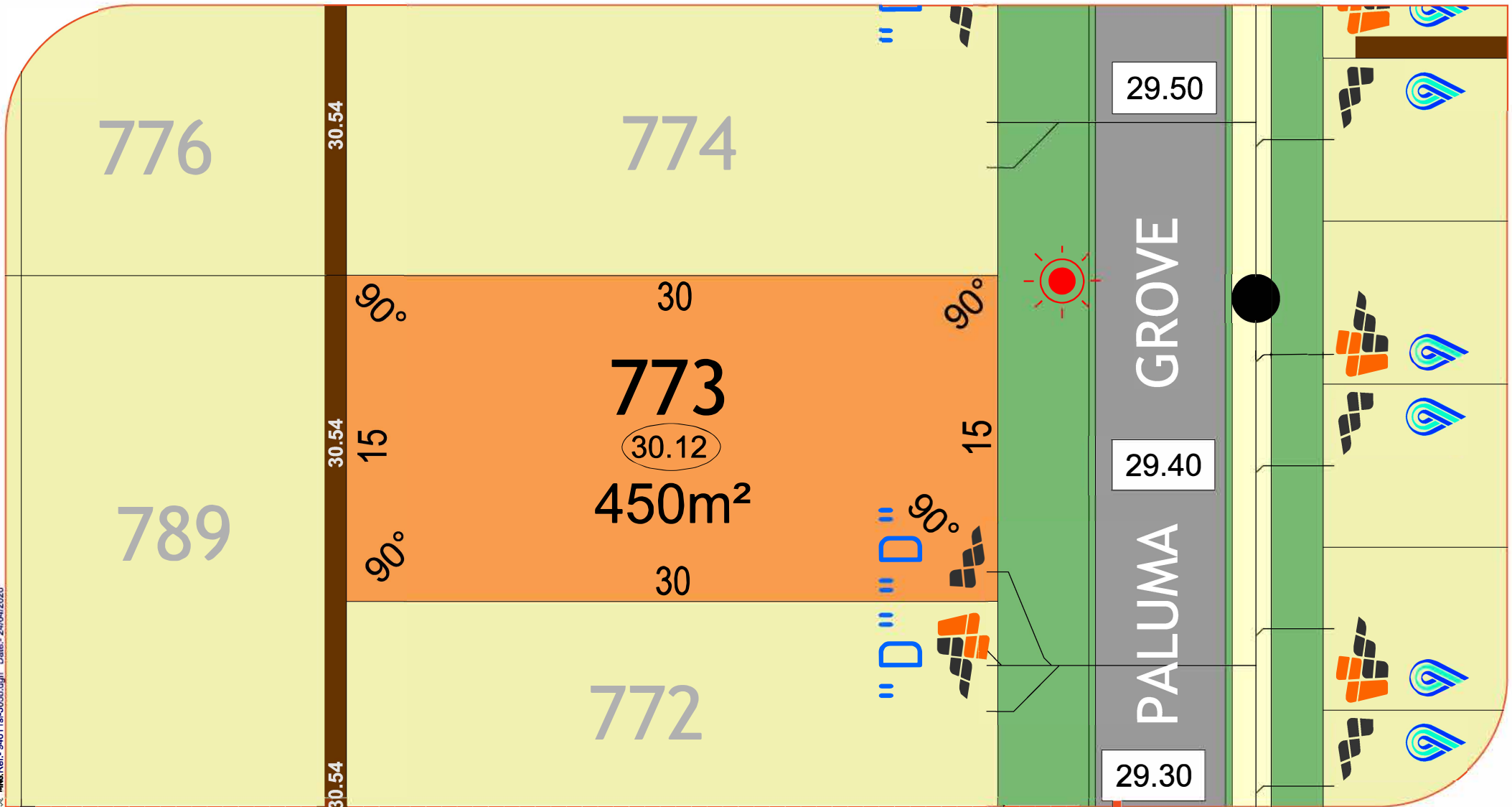

LEGEND:

- | | | | | | | | | | | | | | | | |
|--------------------------|------------|----------------|---------|-----------------------|-----------|------------|-----------|-----------------------------------|--|----------------------|-------|------------------------------|----------|--------|--------------|
| Drainage Services | Manhole | Side Entry Pit | Grate | Electrical | Powerdome | Connection | Lightpole | Footpath | | Lot Levels | 34.67 | Bushfire Attack Level | BAL 12.5 | BAL 29 | NORTH |
| Sewer Line | Manhole | Connection | | Brick Paving | | | | Retaining Wall | | Road Level | 39.50 | BAL 19 | BAL 40 | | |
| Water Services | Connection | Valve | Hydrant | Social Housing | | | | Vehicle Access Restriction | | Padmount site | | Garage Location | | | |
| | 'D' | | | | | | | | | | | | | | |

All Dimensions and Areas are subject to survey. The particulars on this brochure are supplied for identification purposes only and shall not be taken as a representation in any aspect on the part of the vendor or its agents. Authorities should be consulted when services are contained within lot boundaries as building restrictions may apply. All retaining walls, services and associated easements are shown exaggerated for legibility.

Scale 1:250

MWA Ref: 94611sl-305b.dgn Date: 24/04/2020

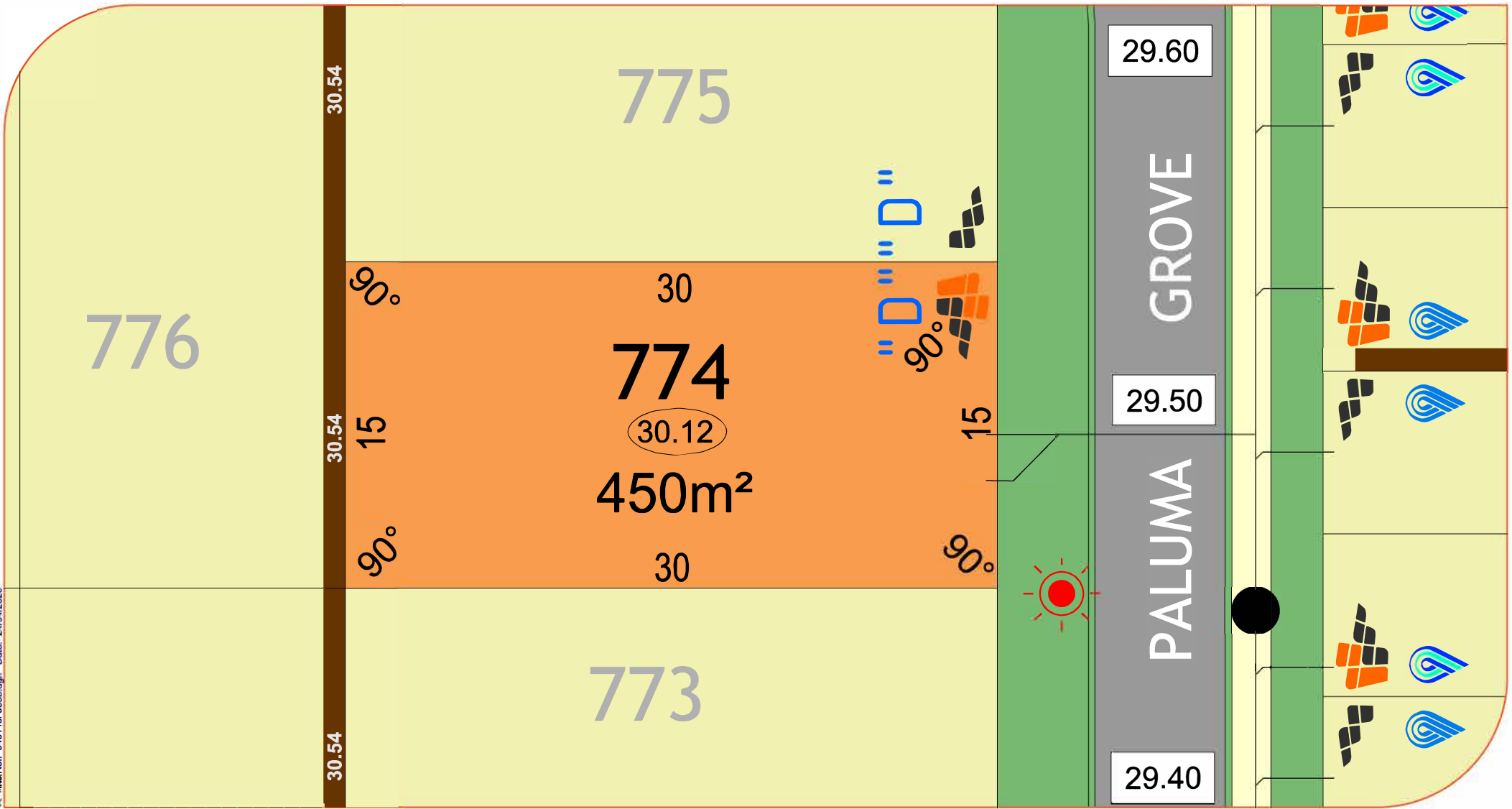

LEGEND:

- | | | | | | | | | | | | | | | | |
|--------------------------|------------|----------------|---------|-----------------------|-----------|------------|-----------|-----------------------------------|--|----------------------|-------|------------------------------|----------|--------|--------------|
| Drainage Services | Manhole | Side Entry Pit | Grate | Electrical | Powerdome | Connection | Lightpole | Footpath | | Lot Levels | 34.67 | Bushfire Attack Level | BAL 12.5 | BAL 29 | NORTH |
| Sewer Line | Manhole | Connection | | Brick Paving | | | | Retaining Wall | | Road Level | 39.50 | BAL 19 | BAL 40 | | |
| Water Services | Connection | Valve | Hydrant | Social Housing | | | | Vehicle Access Restriction | | Padmount site | | Garage Location | | | |
| | 'D' | | | | | | | | | | | | | | |

All Dimensions and Areas are subject to survey. The particulars on this brochure are supplied for identification purposes only and shall not be taken as a representation in any aspect on the part of the vendor or its agents. Authorities should be consulted when services are contained within lot boundaries as building restrictions may apply. All retaining walls, services and associated easements are shown exaggerated for legibility.

Scale 1:250



MWA Ref: 94611sl-305b.dgn Date: 24/04/2020

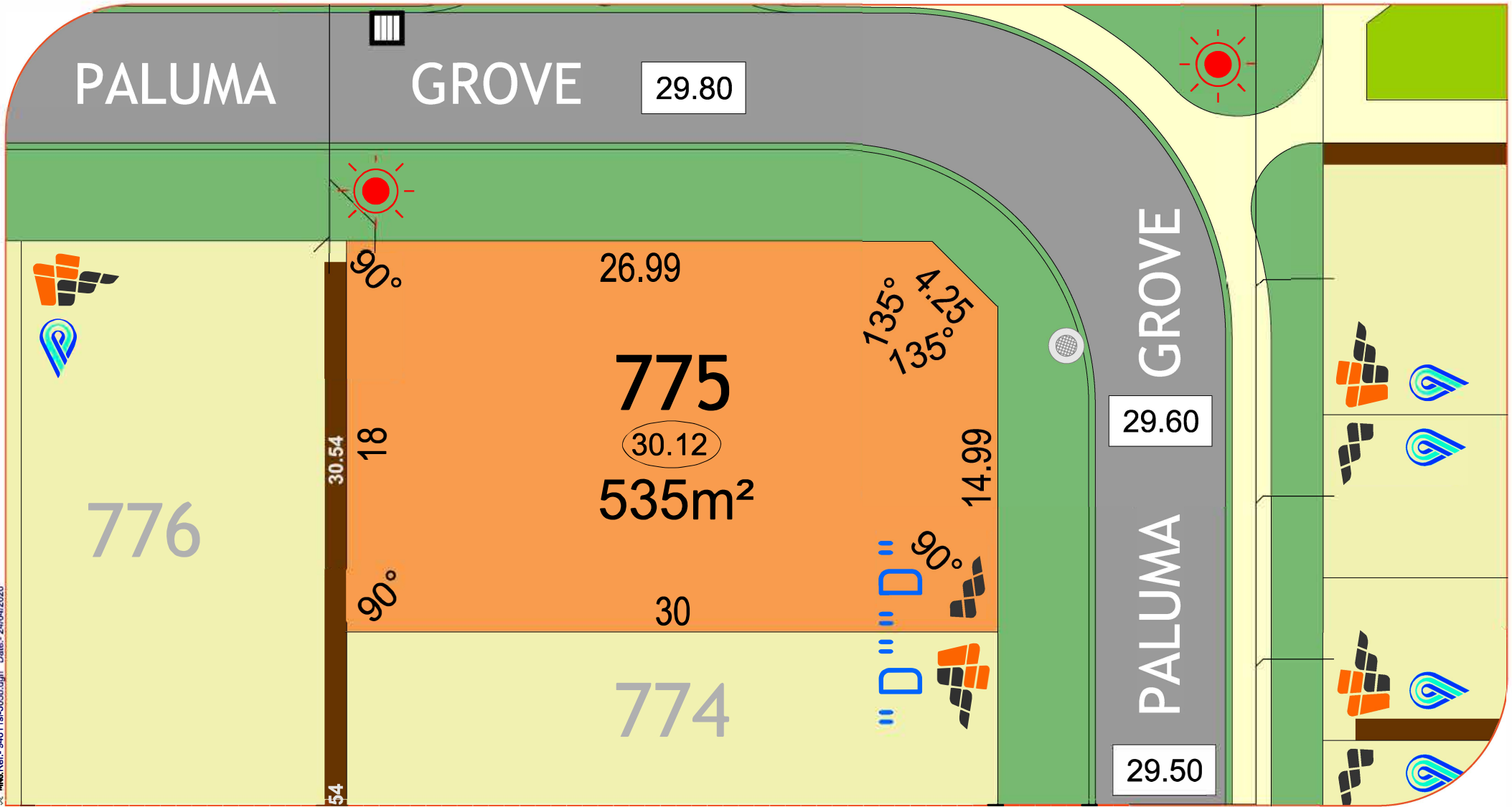

LEGEND:

- | | | | | | | | | | | | | | | |
|--------------------------|------------|----------------|---------|-----------------------|-----------|------------|-----------|-----------------------------------|--|----------------------|-------|------------------------------|----------|--------|
| Drainage Services | Manhole | Side Entry Pit | Grate | Electrical | Powerdome | Connection | Lightpole | Footpath | | Lot Levels | 34.67 | Bushfire Attack Level | BAL 12.5 | BAL 29 |
| Sewer Line | Manhole | Connection | | Brick Paving | | | | Retaining Wall | | Road Level | 39.50 | BAL 19 | BAL 40 | |
| Water Services | Connection | Valve | Hydrant | Social Housing | | | | Vehicle Access Restriction | | Padmount site | | Garage Location | | |
| | 'D' | | | | | | | | | | | | | |

All Dimensions and Areas are subject to survey. The particulars on this brochure are supplied for identification purposes only and shall not be taken as a representation in any aspect on the part of the vendor or its agents. Authorities should be consulted when services are contained within lot boundaries as building restrictions may apply. All retaining walls, services and associated easements are shown exaggerated for legibility.

NORTH

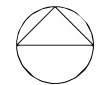

Scale 1:250



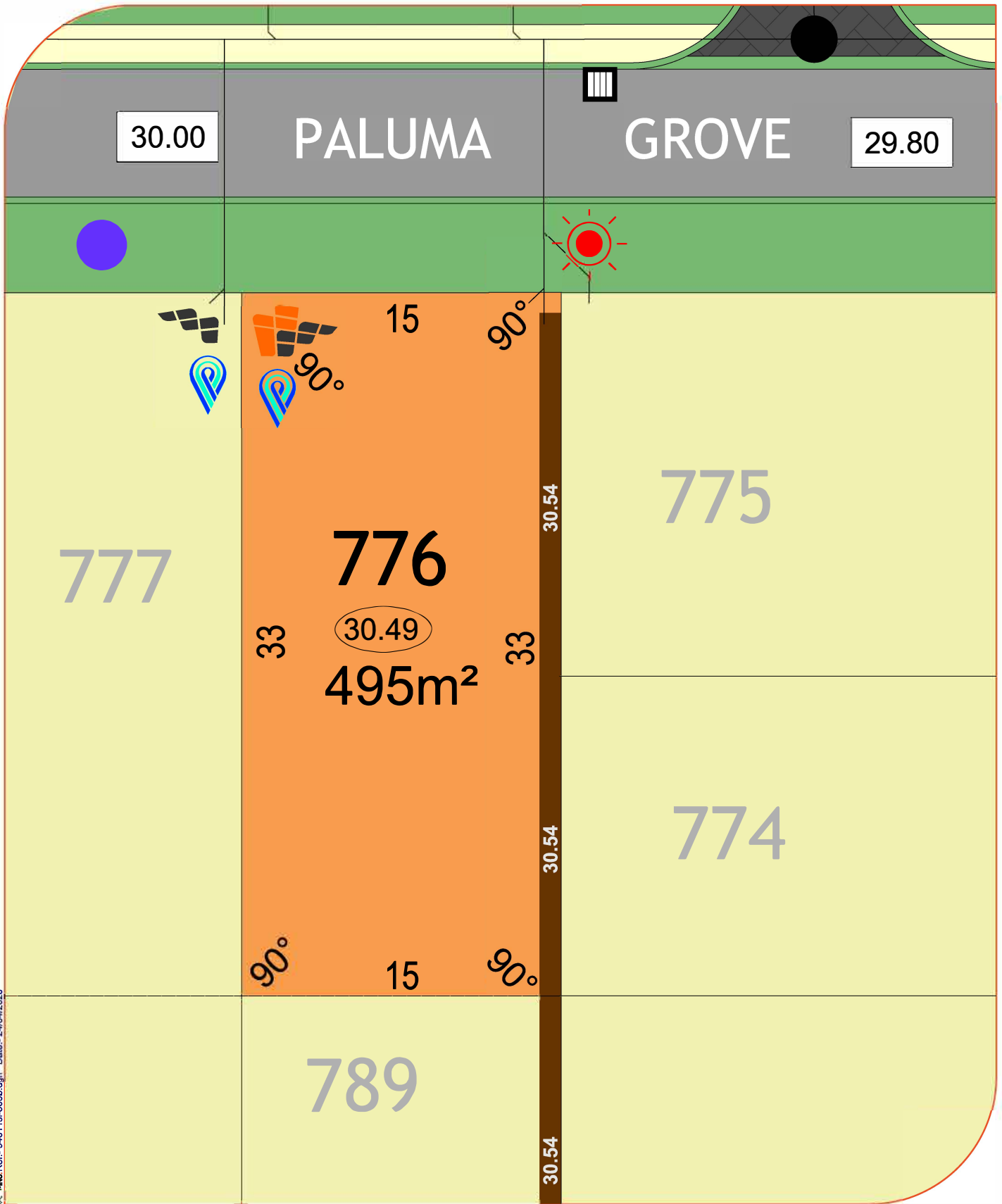

MNG Ref: 94611si-305b.dgn Date: 24/04/2020

LEGEND:

- | | | | |
|---|--|--|---|
| <p>Drainage Services</p> <ul style="list-style-type: none"> Manhole Side Entry Pit Grate <p>Sewer Line</p> <ul style="list-style-type: none"> Manhole Connection <p>Electrical</p> <ul style="list-style-type: none"> Powerdome Connection Lightpole <p>Water Services</p> <ul style="list-style-type: none"> Connection Valve Hydrant Deferred | <p>Brick Paving</p> <p>Social Housing</p> <p>Footpath</p> <p>Retaining Wall</p> <p>Vehicle Access Restriction</p> <p>Garage Location</p> | <p>Padmount site</p> <p>Lot Levels</p> <p>Road Level</p> <p>Bushfire Attack Level</p> <ul style="list-style-type: none"> BAL 12.5 BAL 19 BAL 29 BAL 40 | <p>NORTH</p> <p>Scale 1:250</p> |
|---|--|--|---|

All Dimensions and Areas are subject to survey. The particulars on this brochure are supplied for identification purposes only and shall not be taken as a representation in any aspect on the part of the vendor or its agents. Authorities should be consulted when services are contained within lot boundaries as building restrictions may apply. All retaining walls, services and associated easements are shown exaggerated for legibility.



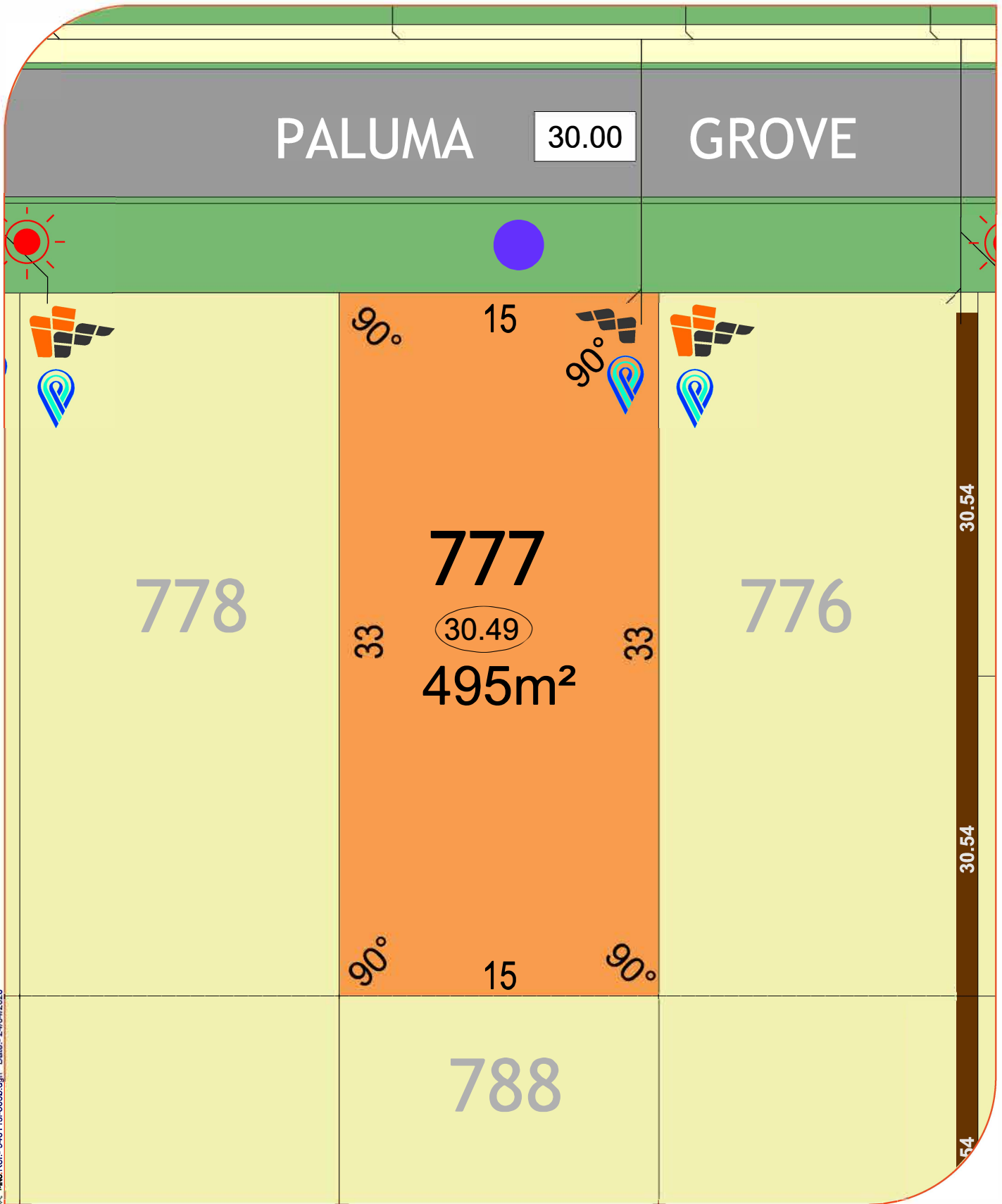

MNG Ref. 94611si-305b.dgn Date: 24/04/2020

LEGEND:

- | | | | | | | | |
|--------------------------|------------|----------------|-----------|-----------------------------------|--|------------------------------|-------|
| Drainage Services | Manhole | Side Entry Pit | Grate | Brick Paving | | Padmount site | |
| Sewer Line | Manhole | Connection | | Social Housing | | Lot Levels | 34.67 |
| Electrical | Powerdome | Connection | Lightpole | Footpath | | Road Level | 39.50 |
| Water Services | Connection | Valve | Hydrant | Retaining Wall | | Bushfire Attack Level | |
| | | | Deferred | Vehicle Access Restriction | | BAL 12.5 | |
| | | | | Garage Location | | BAL 19 | |
| | | | | | | BAL 29 | |
| | | | | | | BAL 40 | |

NORTH



Scale 1:250

All Dimensions and Areas are subject to survey. The particulars on this brochure are supplied for identification purposes only and shall not be taken as a representation in any aspect on the part of the vendor or its agents. Authorities should be consulted when services are contained within lot boundaries as building restrictions may apply. All retaining walls, services and associated easements are shown exaggerated for legibility.



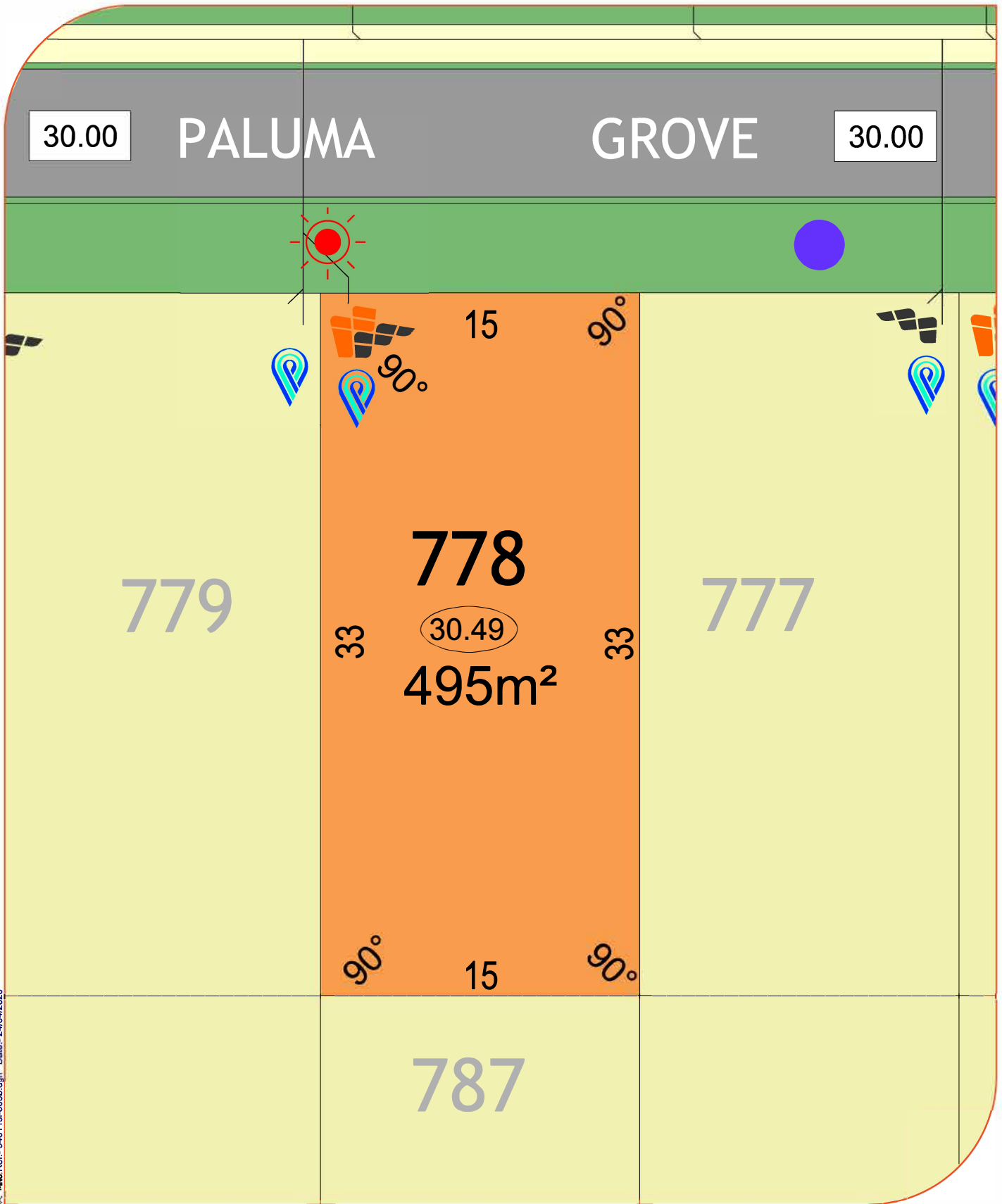

MNG Ref. 94611si-305b.dgn Date: 24/04/2020

LEGEND:

- | | | | | | | | | |
|--------------------------|------------|----------------|-----------|-----------------------------------|--|------------------------------|--------|------------------|
| Drainage Services | Manhole | Side Entry Pit | Grate | Brick Paving | | Padmount site | | NORTH
 |
| Sewer Line | Manhole | Connection | | Social Housing | | Lot Levels | 34.67 | |
| Electrical | Powerdome | Connection | Lightpole | Footpath | | Road Level | 39.50 | |
| Water Services | Connection | Valve | Hydrant | Retaining Wall | | Bushfire Attack Level | | |
| | Deferred | | | Vehicle Access Restriction | | BAL 12.5 | BAL 29 | |
| | | | | Garage Location | | BAL 19 | BAL 40 | |

All Dimensions and Areas are subject to survey. The particulars on this brochure are supplied for identification purposes only and shall not be taken as a representation in any aspect on the part of the vendor or its agents. Authorities should be consulted when services are contained within lot boundaries as building restrictions may apply. All retaining walls, services and associated easements are shown exaggerated for legibility.



30.00

PALUMA

GROVE

30.00

780

779

778

30.49
578m²

786

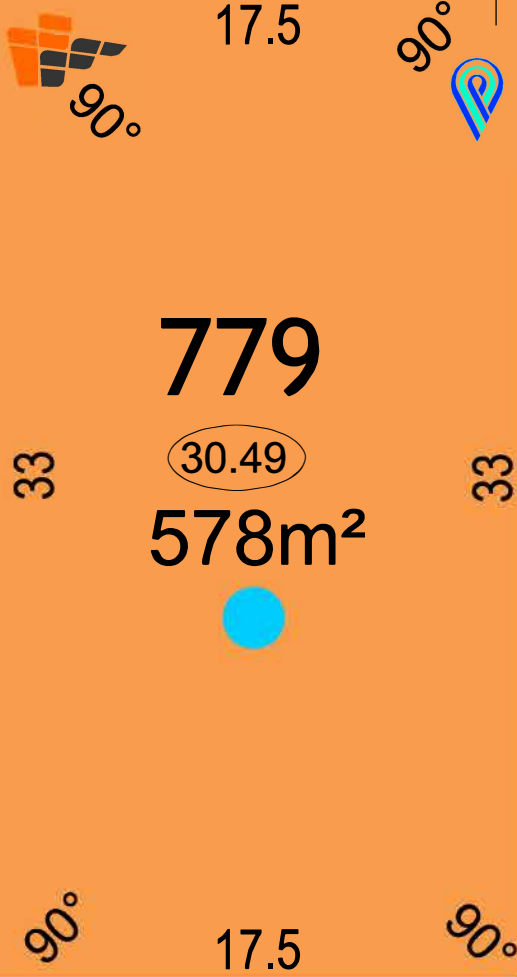

LEGEND:

Drainage Services



Sewer Line

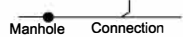

Electrical



Water Services



Brick Paving



Social Housing



Footpath



Retaining Wall



Vehicle Access Restriction



Garage Location



Padmount site



Lot Levels



Road Level



Bushfire Attack Level



NORTH



Scale 1:250

MNG Ref. 94611si-305b.dgn Date: 24/04/2020

All Dimensions and Areas are subject to survey. The particulars on this brochure are supplied for identification purposes only and shall not be taken as a representation in any aspect on the part of the vendor or its agents. Authorities should be consulted when services are contained within lot boundaries as building restrictions may apply. All retaining walls, services and associated easements are shown exaggerated for legibility.



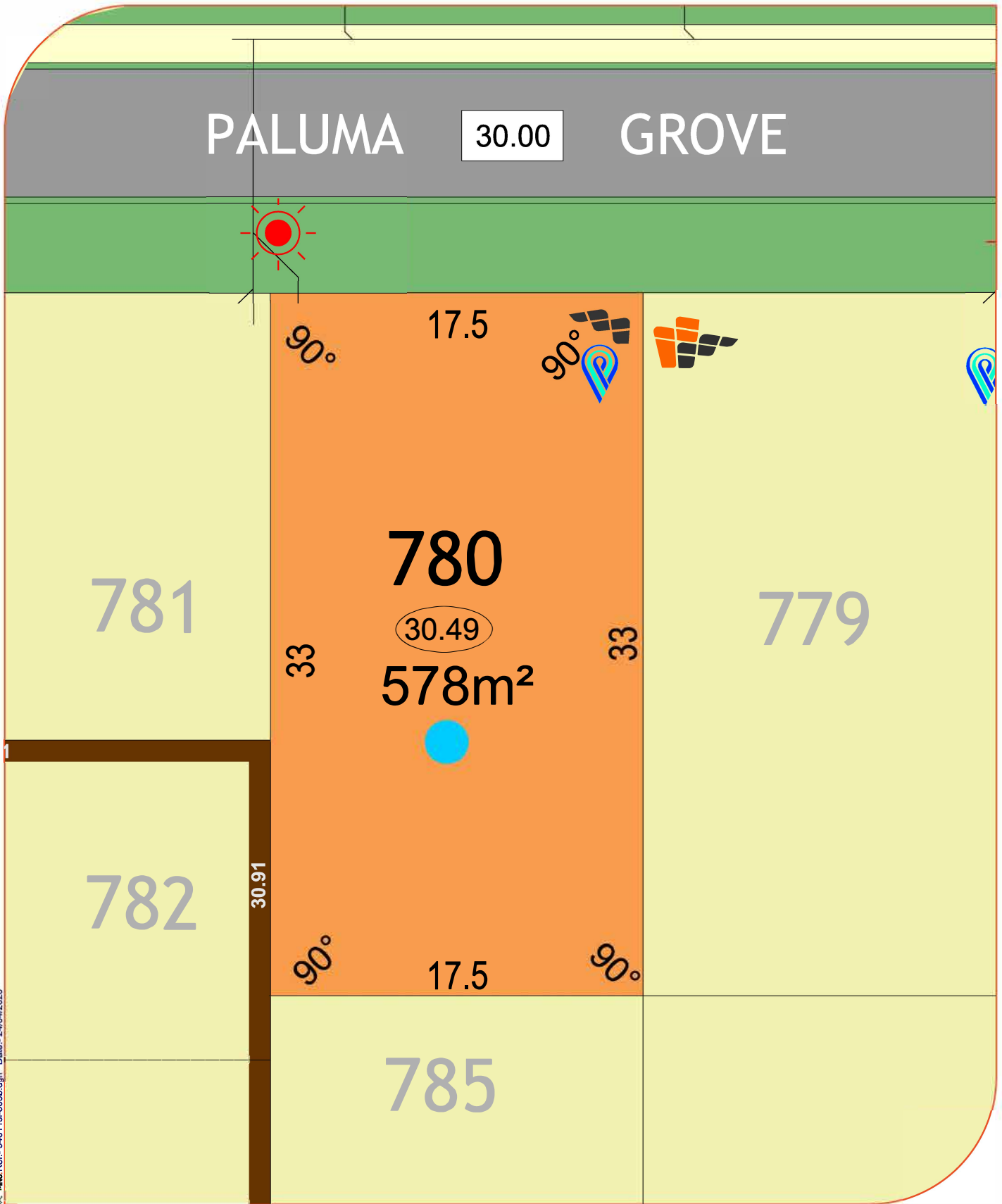

MNG Ref. 94611si-305b.dgn Date: 24/04/2020

LEGEND:

- | | | | |
|---|--|--|---|
| <p>Drainage Services</p> <ul style="list-style-type: none"> Manhole Side Entry Pit Grate <p>Sewer Line</p> <ul style="list-style-type: none"> Manhole Connection <p>Electrical</p> <ul style="list-style-type: none"> Powerdome Connection Lightpole <p>Water Services</p> <ul style="list-style-type: none"> Connection Valve Hydrant Deferred | <p>Brick Paving</p> <p>Social Housing</p> <p>Footpath</p> <p>Retaining Wall</p> <p>Vehicle Access Restriction</p> <p>Garage Location</p> | <p>Padmount site</p> <p>Lot Levels</p> <p>Road Level</p> <p>Bushfire Attack Level</p> <ul style="list-style-type: none"> BAL 12.5 BAL 19 BAL 29 BAL 40 | <p>NORTH</p> <p>Scale 1:250</p> |
|---|--|--|---|

All Dimensions and Areas are subject to survey. The particulars on this brochure are supplied for identification purposes only and shall not be taken as a representation in any aspect on the part of the vendor or its agents. Authorities should be consulted when services are contained within lot boundaries as building restrictions may apply. All retaining walls, services and associated easements are shown exaggerated for legibility.



MWA Ref: 94611sl-303b.dgn Date: 24/04/2020

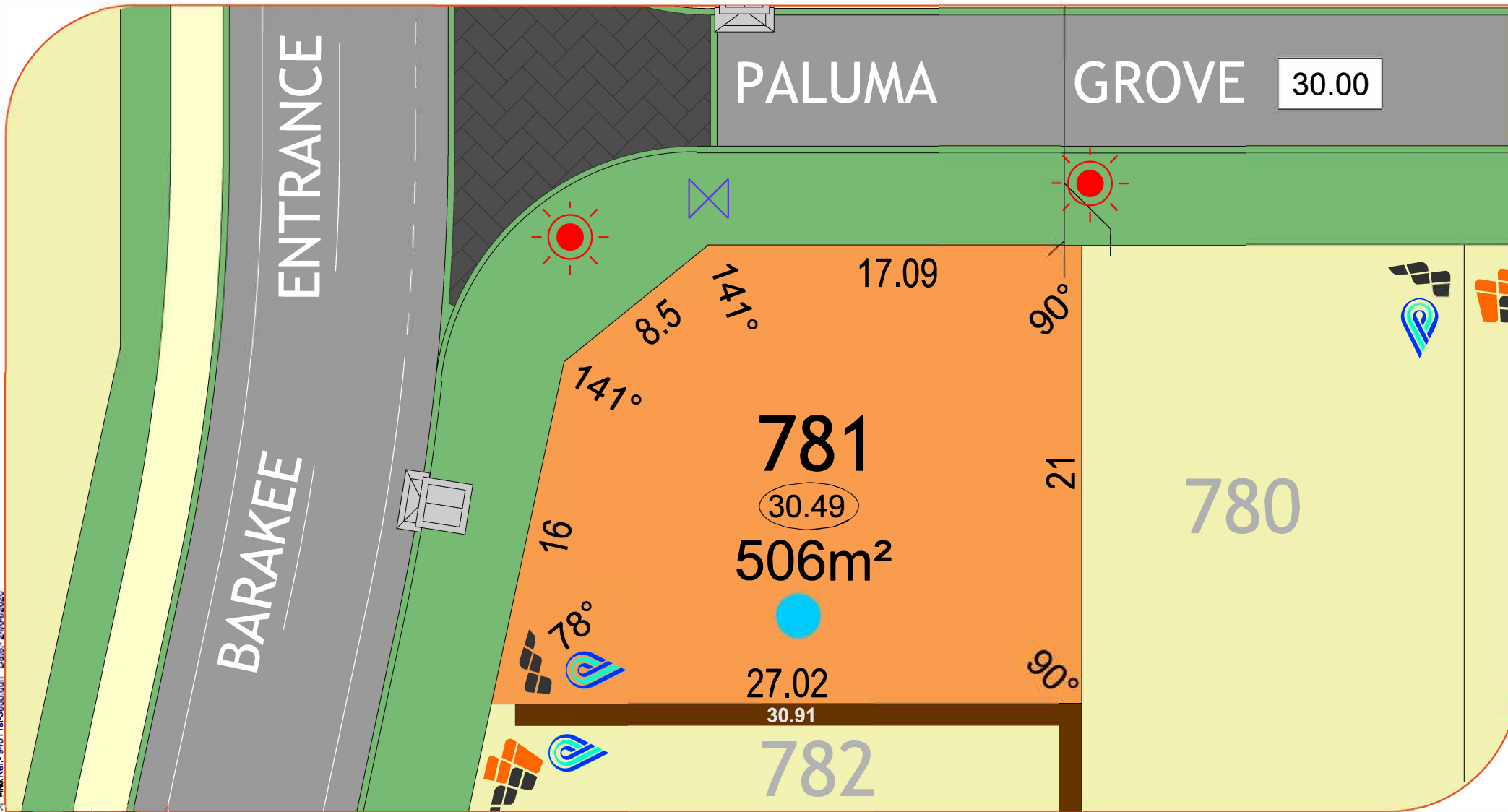

LEGEND:

Drainage Services	Manhole	Side Entry Pit	Grate	Electrical	Powerdome	Connection	Lightpole	Footpath		Lot Levels	34.67	Bushfire Attack Level	
Sewer Line	Manhole	Connection		Brick Paving				Retaining Wall		Road Level	39.50	BAL 12.5	BAL 29
Water Services	Connection	Valve	Hydrant	Social Housing				Vehicle Access Restriction		Padmount site		BAL 19	BAL 40
	'D'											Garage Location	

NORTH

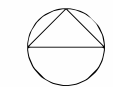

Scale 1:250

All Dimensions and Areas are subject to survey. The particulars on this brochure are supplied for identification purposes only and shall not be taken as a representation in any aspect on the part of the vendor or its agents. Authorities should be consulted when services are contained within lot boundaries as building restrictions may apply. All retaining walls, services and associated easements are shown exaggerated for legibility.

